

# SF23BSET

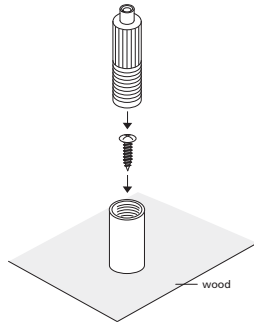

## °SF23BSET

SF23 is a floor tensioner that also works well as a turnbuckle for balustrades. Use it to tension cables to minimize the movement of displays.

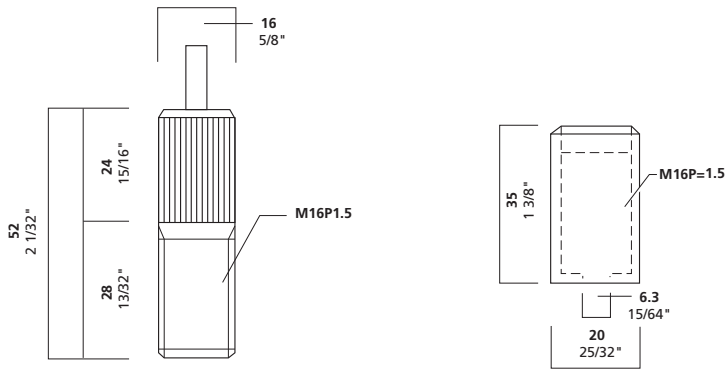

## ° Product Information

### cable size

1/16" 1.5 mm  
3/32" 2.5 mm

### maximum weight

1/16": 65 lbs. 30 kg  
3/32": 155 lbs. 70 kg

### function

tensioner: floor, surface mount: concrete, wood, tile

### installation instructions

Attach socket to wood floor with #12 screw. Attach to concrete floor with 1/4-20 anchor. Bolt or screw socket to floor. Adjust ceiling connector so cable is 1 1/4 inch from the floor. Thread tensioner into socket two turns. Insert cable. Turn tensioner down by HAND.

2-3

## ° Companion Products, please see their individual information sheets.



°SF23ASET



°SF23CSET



°SF23DSET

## Arakawa Hanging Systems

2505 SE 11th Avenue, Suite 122  
Portland, Oregon 97202  
phone: 503.236.0440  
fax: 503.236.0427  
toll free: 888.272.5292

[www.arakawagrip.com](http://www.arakawagrip.com)



Copyright © 2007 Arakawa & Co., Ltd. All rights reserved. Arakawa products are covered by U.S. and foreign patents, issued and pending. Specification and price change privileges reserved.